

The Estate Agent People Recommend



1 Headley Close,  
Woodley  
RG5 4SF

Price guide £425,000



Welcome to this charming property located in a sought-after cul de sac in North Woodley. This delightful three storey end terrace house boasts a lovely reception room on the first floor, spacious kitchen/dining room on the ground floor with access to the private rear garden, perfect for relaxing or entertaining guests. With three bedrooms, there is ample space for a growing family or for the third bedroom to be used as a home office. There is plenty of living space, with good size rooms, double glazing and gas central heating.

The property features a refurbished family bathroom, with wash hand basin and storage under, WC and bath with shower over offering convenience and comfort. Parking will never be an issue with space for two vehicles and a garage with access from the hallway for the washing machine and dryer and further storage.

In a peaceful neighbourhood, this property offers a tranquil retreat from the hustle and bustle of daily life. The location provides easy access to local amenities, shops, schools, and transport links, making it an ideal choice for those seeking both convenience and a sense of community.

Don't miss out on the opportunity to make this lovely house your new home. Book a viewing today and envision the possibilities that await in this wonderful property on Headley Close.

## ACCOMMODATION

- THREE BEDROOM END TOWNHOUSE
- SPACIOUS ACCOMODATION
- ACCESS TO THE GARAGE AND UTILITY AREA
- GOOD SIZE KITCHEN/DINING ROOM
- DRIVEWAY PARKING AND GARAGE
- GAS CENTRAL HEATING AND DOUBLE GLAZING
- WALKING DISTANCE TO TOWN CENTRE
- EPC - D
- FREEHOLD

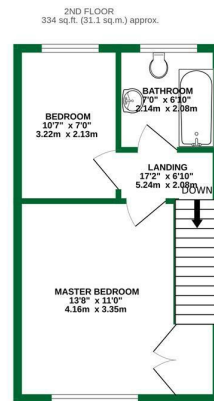
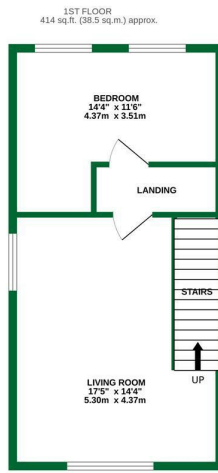
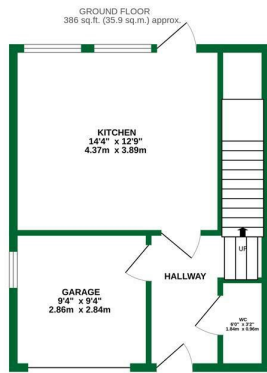

TOTAL FLOOR AREA: 1135 sq.ft. (105.4 sq.m.) approx.

Whilst every attempt has been made to ensure the accuracy of the floorplan contained here, measurements of doors, windows, rooms and any other items are approximate and no responsibility is taken for any error, omission or mis-statement. This plan is for illustrative purposes only and should be used as such by any prospective purchaser. The services, systems and appliances shown have not been tested and no guarantee as to their operability or efficiency can be given.  
Made with Metropix ©2024



The Old Butchers, 15 High Street, Twyford, Berkshire, RG10 9AB  
t: 0118 934 0027 e: twyford@wentworthea.com

IMPORTANT: we would like to inform prospective purchasers that these sales particulars have been prepared as a general guide only. A detailed survey has not been carried out, nor the services, appliances and fittings tested. Room sizes should not be relied upon for furnishing purposes and are approximate. If floor plans are included, they are for guidance only and illustration purposes only and may not be to scale. If there are any important matters likely to affect your decision to buy, please contact us before viewing the property.



wentworth\_ea



wentworthestateagents